

Sapperton

2006 Census

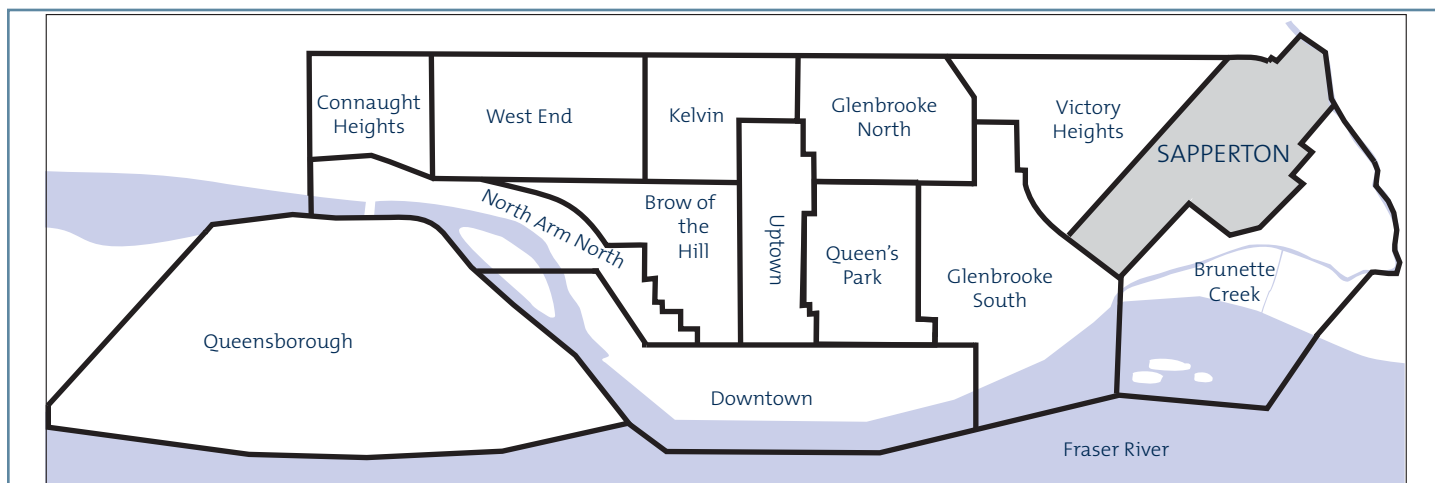

A Note About Neighbourhood Profiles

All data in tables, charts, and text is from Statistics Canada, based on the 2006 and 2001 Census. References in the text to “more”, “fewer”, or “similar” are all based on comparisons with Census figures for the City of New Westminster as a whole. For assistance, please contact the City of New Westminster Planning Division at 604.527.4532 or plnpost@newwestcity.ca.

Distinct Neighbourhood Features

Sapperton is a slower growing part of the City, showing just a 2% increase in population between 2001 and 2006. Its age profile is very similar to the City's, with slightly fewer young children and seniors aged 70-79, and slightly more adults aged 35-49. There are more couples with children, and significantly fewer total households have moved within the last 5 years. It has a slightly higher median household income than the City. There is a diverse mix of housing types, with the exact same proportion of owner/renter households as the City. Fewer renter households struggle with affordability. More residents work in business/finance/administration and health, and fewer work in sales and service. English is more prevalent as a home language, spoken by 83% of residents in Sapperton vs. 79% City-wide. The Philippines is the most significant source country of immigrants, both overall and particularly in relation to recent immigrants. Bulgaria is also a notable source country of recent immigrants, and after English, Bulgarian is the second most common home language.

Population & Age Groups

	New Westminster		Sapperton	
Total population	57,850		4,485	
Age 0 to 4	2,925	5.1%	330	7.4%
Age 5 to 14	5,480	9.5%	425	9.5%
Age 15 to 24	6,410	11.1%	485	10.8%
Age 25 to 34	8,700	15.0%	615	13.7%
Age 35 to 49	15,795	27.3%	1,295	28.9%
Age 50 to 69	13,215	22.8%	1,050	23.4%
Age 70 to 79	3,140	5.4%	135	3.0%
Age 80 and above	2,195	3.8%	165	3.7%

- Total population is up 2.2% since 2001, compared with 7.5% City-wide.
- Sapperton makes up 7.8% of the City's population.
- Compared to the City, Sapperton has 2% more children aged 4 and under, 2% more aged 35 to 49, and 2% fewer aged 70 to 79.

Population & Age Groups

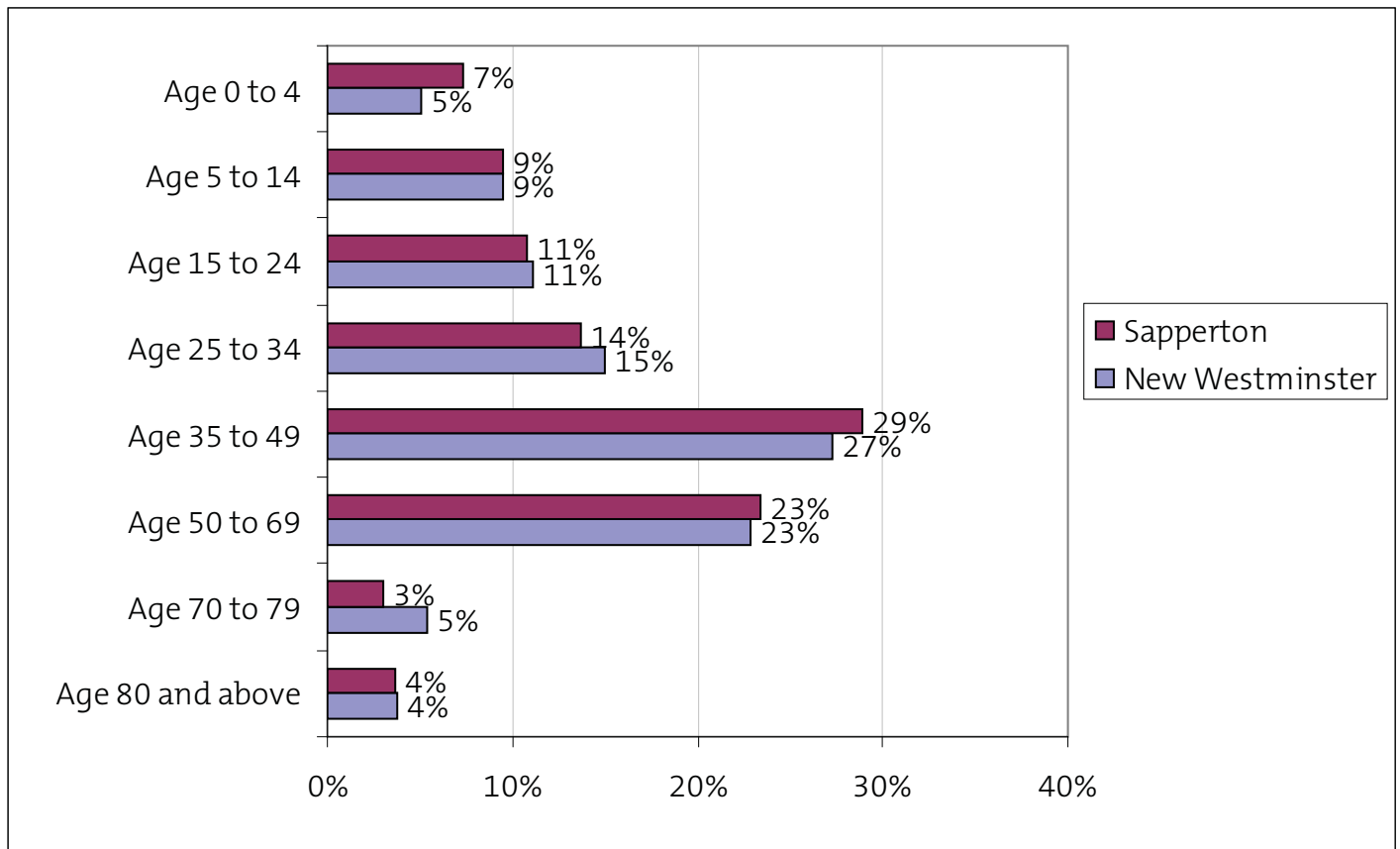

Types of Households & Mobility

	New Westminster		Sapperton	
Total Family and Household Types*	27,585		2,050	
Living Alone	10,700	38.8%	750	36.6%
Couple Without Children	6,700	24.3%	475	23.2%
Couple With Children	6,280	22.8%	545	26.6%
Single Parent Family	2,605	9.4%	210	10.2%
Other	1,300	4.7%	70	3.4%
Total Households*	27,050		2,000	
Multiple-Family Households	505	1.9%	50	2.5%
Average Household Size	2.1		2.2	
Population moved within last 5 years	28,885	52.6%	1,725	41.4%

- Sapperton's household mix has 4% more couples with children, and 2% fewer persons living alone.
- In Sapperton, 11% fewer households have moved within the last 5 years.

*Note: The total of family/household types is greater than the number of total households because some families live together in multiple-family households.

Types of Households

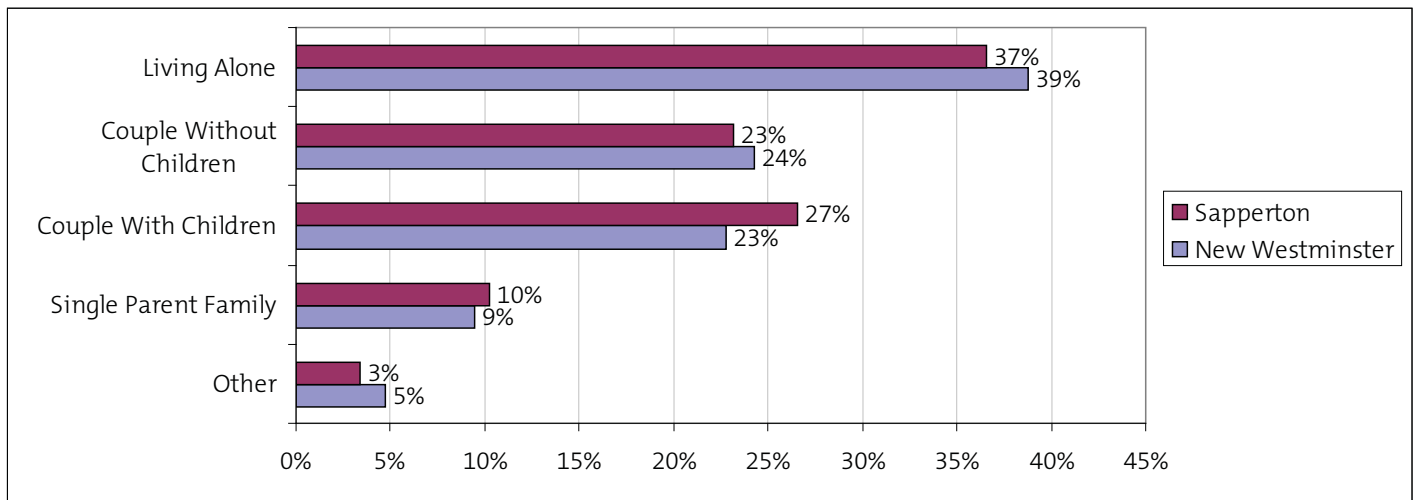

Household Income

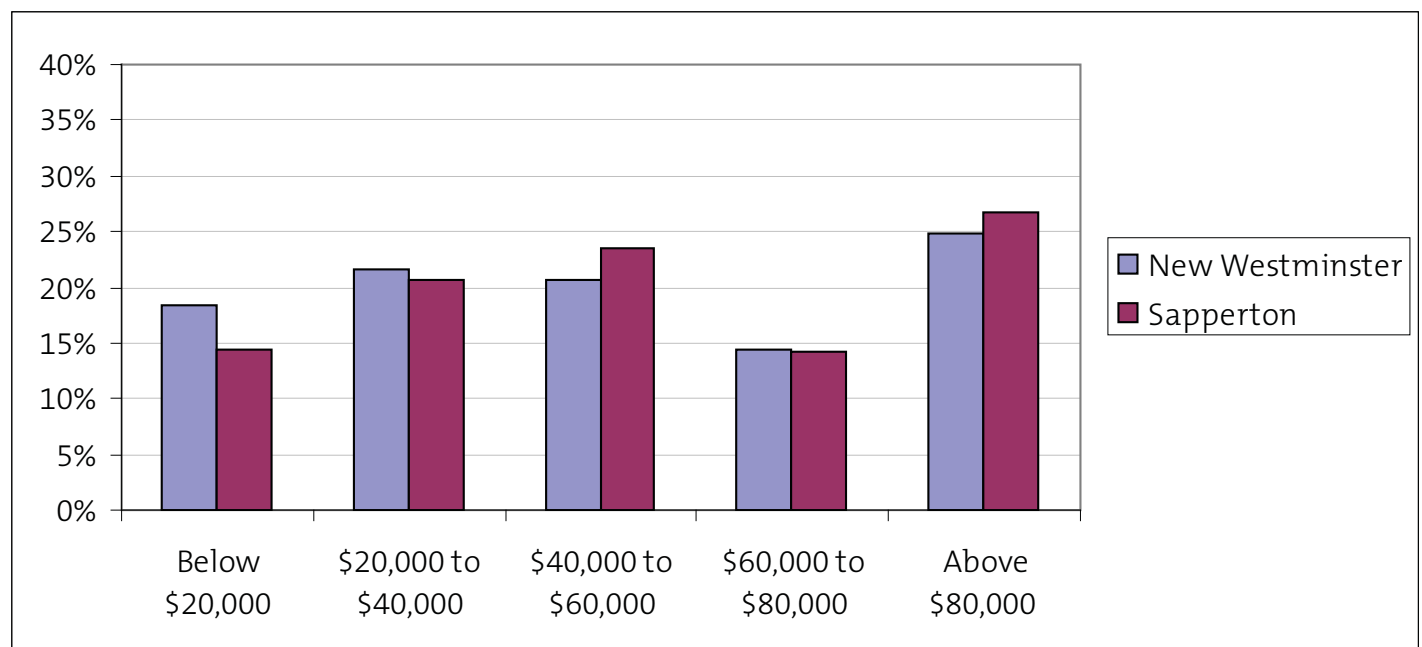

Household Income

Household income in 2005	New Westminster		Sapperton	
Total Households	27,045		2,000	
Below \$20,000	4,995	18.5%	290	14.5%
\$20,000 to \$40,000	5,870	21.7%	415	20.8%
\$40,000 to \$60,000	5,575	20.6%	470	23.5%
\$60,000 to \$80,000	3,890	14.4%	285	14.3%
Above \$80,000	6,720	24.8%	535	26.8%
Median household income	\$ 48,773		\$ 50,083	
Average household income	\$ 60,408		\$ 62,985	
Prevalence of low income		20.3%		17.9%

- Sapperton's income profile is very similar to the City-wide pattern. Compared to the City, in Sapperton there are 4% fewer households in the lowest income category, and 3% more in the \$40,000 to \$60,000 income category.
- Sapperton's median household income is 3% higher than the City's. There is also a slightly lower prevalence of low income (18%), about 2% below the City-wide rate.

Housing Types, Tenure & Affordability

	New Westminster		Sapperton	
Total Occupied Dwellings	27,050		2,000	
Apartment	17,875	66.1%	815	40.8%
Townhouse/Duplex	1,145	4.2%	55	2.8%
Single Family	5,055	18.7%	645	32.3%
Single Family with Suite	1,458	5.4%	230	11.5%
Secondary Suite	1,458	5.4%	230	11.5%
Rented	12,495	46.2%	920	46.0%
Owned	14,555	53.8%	1,075	53.8%
Tenant households spending 30% or more of income on housing	4,895	39.2%	305	33.2%
Owner households spending 30% or more of income on housing	3,710	25.5%	300	27.9%

- There is a diverse mix of housing in the neighbourhood. Households living in apartments comprise a 25% lower share than City-wide. The share of households living in single family homes is 15% higher than City-wide. Houses with secondary suites are also more common in Sapperton.
- Sapperton's mix of owner vs. renter households is identical to the City's. 33% of renter households struggle with affordability, which is 6% lower than the City-wide rate. There is a slightly higher share of owners facing affordability challenges.

Education

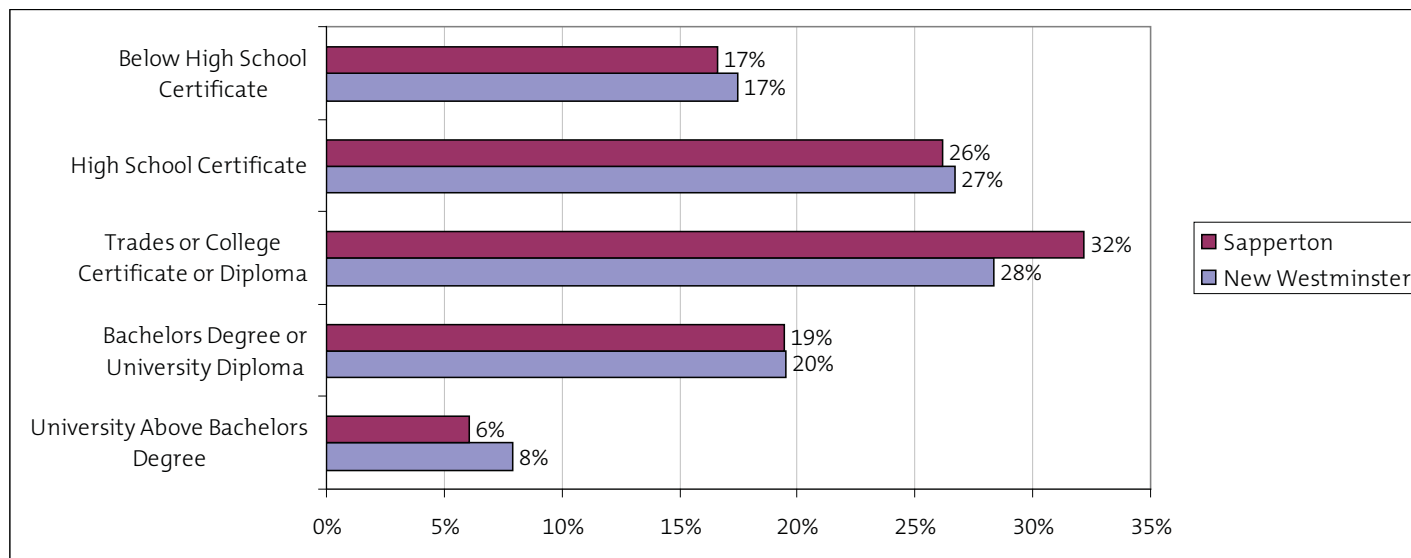

Education

	New Westminster		Sapperton	
Population Aged 15 and over	49,455		3,730	
Below High School Certificate	8,640	17.5%	620	16.6%
High School Certificate	13,210	26.7%	975	26.1%
Trades or College Certificate or Diploma	14,025	28.4%	1,200	32.2%
Bachelors Degree or University Diploma	9,665	19.5%	725	19.4%
University Above Bachelors Degree	3,910	7.9%	225	6.0%

- Sapperton has a 4% higher share of persons with a trades/ college diploma, and a 2% lower share of residents with university education above the Bachelor's level.
- Sapperton's labour force participation rate is 3% higher than the City's. It has the same unemployment rate as the City.
- Business, finance, and administration is the most common occupational group for Sapperton residents.

Labour Force

	New Westminster	Sapperton
Population 15 years and over	49,455	3,730
Labour force 15 years and over	34,260	2,705
Participation rate	69.3%	72.7%
Unemployment rate	5.6%	5.9%
Live and Work in New Westminster (incl. home-based)	20.2%	19.6%

- In Sapperton, there are several differences in occupations compared to the City: 5% fewer residents employed in sales and service; 4% more in business, finance and administration; 4% more in health; and 3% fewer in social science, education, and government.

Occupations

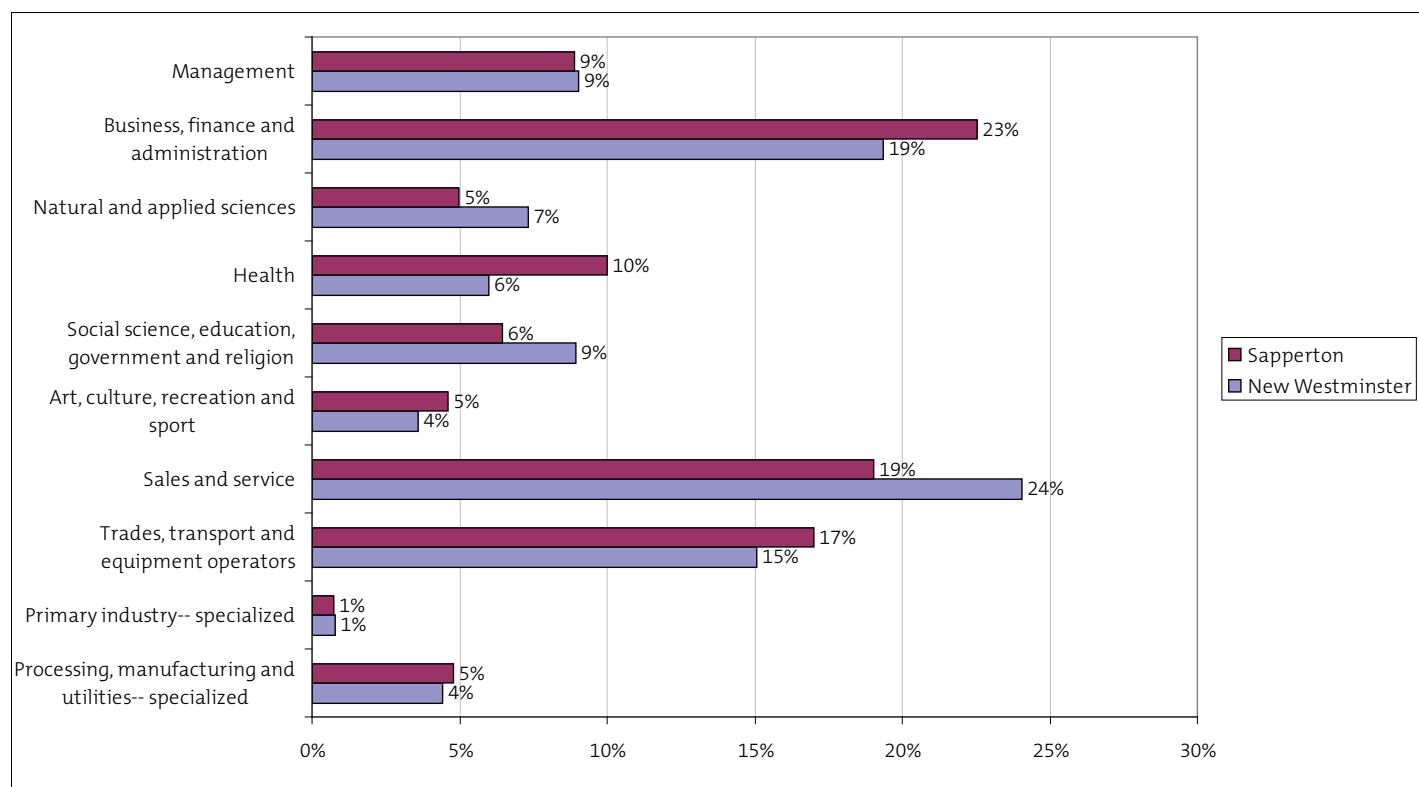

Mode of Travel to Work

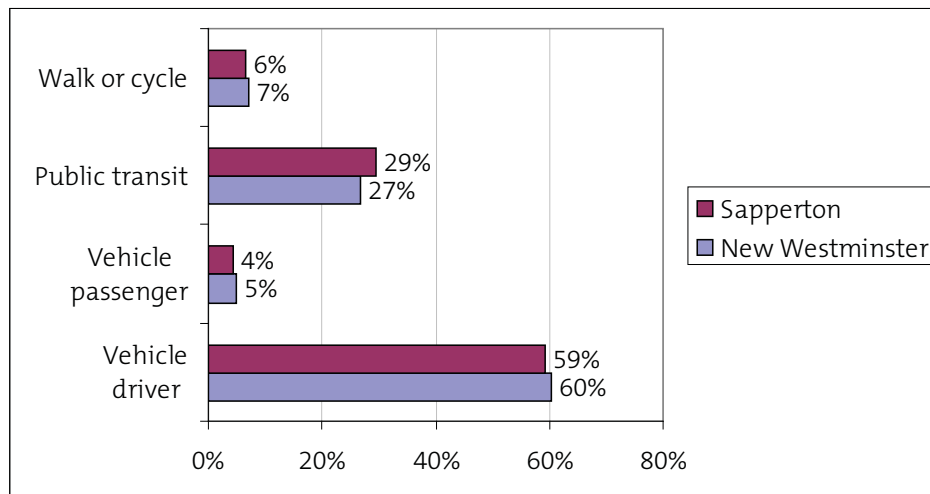

- Sapperton residents are 2% more likely to take transit to work.
- Transit's share of work trips is up 15% since 2001*, vs. 7% for the City.
- Vehicle driving's share is down 11% since 2001, vs. 5% for the City.

(*The Millennium SkyTrain Line opened in 2002, with a new station at Sapperton).

Ethnic Origin

	New Westminster			Sapperton	
Total population	57,850			4,485	
Single responses	30,775	53.2%		2,340	52.2%
Multiple responses	27,075	46.8%		2,145	47.8%
Top 10 Ethnicities			Top 10 Ethnicities		
English	15,405		English	1,295	
Scottish	11,645		Scottish	970	
Canadian	9,245		Irish	755	
Irish	9,020		Canadian	705	
German	6,090		German	550	
French	4,455		Filipino	425	
Chinese	4,245		French	390	
East Indian	4,110		Ukrainian	250	
Filipino	3,380		Chinese	230	
Ukrainian	2,795		Dutch	200	

Note : Table shows both single & multiple responses, so the number of responses is greater than the total population.

Home Language

	New Westminster			Sapperton	
Total population	57,845	100.0%		4,485	
Multiple responses	1,635	2.8%		180	4.0%
Single responses	56,215	97.2%		4,310	96.1%
Top 5 Languages			Top 5 Languages		
English	45,650	78.9%	English	3,720	82.9%
Punjabi	1,785	3.1%	Bulgarian	90	2.0%
Filipino	1,000	1.7%	Korean	85	1.9%
Mandarin	980	1.7%	Filipino	80	1.8%
Korean	820	1.4%	Mandarin	60	1.3%

- Compared to the City, Filipino, Ukrainian, and Dutch ethnic origins are more common in Sapperton. Chinese origins are less common.
- English is 4% more prevalent in Sapperton. It dropped 4% in prevalence between 2001-2006 in Sapperton but increased by 3% City-wide during the same period. English is still predominant, with over 82% of residents using it as their home language.
- Bulgarian is distinct as the second most common home language in Sapperton. Korean, Filipino, and Mandarin have the same share and prominence both City-wide and in Sapperton.

Citizenship & Immigration

	New Westminster			Sapperton	
Total population	57,850			4,485	
Canadian citizens	52,100	90.1%		4,160	92.8%
Not Canadian citizens	5,750	9.9%		330	7.4%
Non-Immigrants	38,630	66.8%		3,250	72.4%
Immigrants	18,360	31.7%		1,225	27.3%
Top 10 Source Countries Overall					
Philippines	2,425	13.2%	Philippines	295	24.1%
India	2,045	11.1%	United Kingdom	130	10.6%
United Kingdom	1,585	8.6%	South Korea	65	5.3%
China	1,430	7.8%	Taiwan	55	4.5%
South Korea	795	4.3%	Trinidad and Tobago	50	4.1%
Romania	615	3.3%	Germany	40	3.3%
Hong Kong	575	3.1%	China	40	3.3%
United States of America	560	3.1%	India	40	3.3%
Fiji	370	2.0%	Poland	30	2.4%
Poland	365	2.0%	Netherlands	30	2.4%
Top 3 Recent Source Countries (2001-2006)					
Total	4,250		Total	285	
Philippines	710	16.7%	Philippines	135	47.4%
China	690	16.2%	Bulgaria	75	26.3%
Romania	435	10.2%	China	15	5.3%

- Compared to the City, Canadian citizens make up a 3% higher proportion of the population in Sapperton.
- Immigrants make up a 4% lower share of the population.
- Compared to the City-wide profile, the Philippines is a much more significant source country of immigrants in Sapperton, with an 11% higher share of total immigrants. Taiwan, and Trinidad and Tobago are also more prominent source countries in this neighbourhood.
- Among recent immigrants, the Philippines is even more prominent as a source country. Almost half (47%) of all recent immigrants living in Sapperton are from the Philippines. Although this country is also ranked first City-wide in relation to recent immigrants, by proportion the Philippines has a 31% higher share in Sapperton. Bulgaria is also distinct, accounting for 26% of recent immigrants in Sapperton. China is less prominent, with an 11% lower share of recent immigrants compared to the City.
- Between 2001-2006, the share of immigrants in the City and in Sapperton grew at the same rate.
- Immigrants in Sapperton were 3% more likely to have come to Canada before 1980.

Period of Immigration

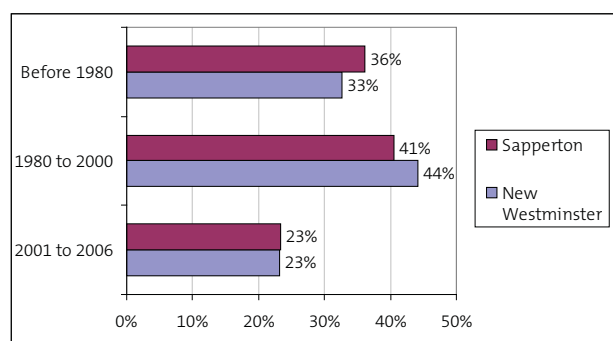

Immigrants' Share of Population

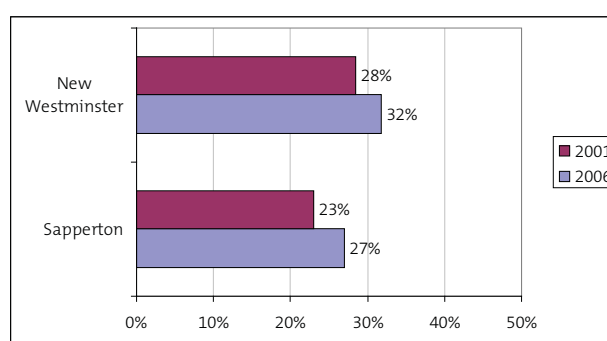

Note: How Numbers Add Up in the Census

The Census uses "random rounding" in its data, to round numbers either up or down to multiples of 5. Because of this, some figures differ slightly. For example, New Westminster population may be shown as either 57,850 or 57,845. Both totals can be considered correct and accurate.